



# WASTE COMPACTOR SEALS

# product data sheet



Marine



Automotive



Roads & Heavy Transport



Building & Construction



Railways



Traffic Information



Refrigeration



No Dig

## B SEAL

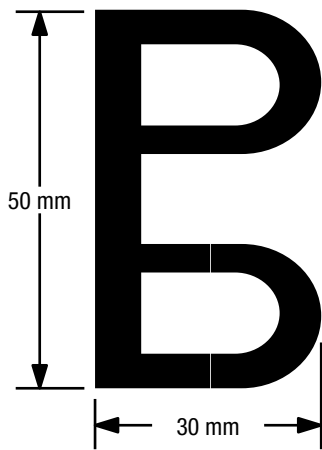

ACTUAL SIZE

## MINI B SEAL

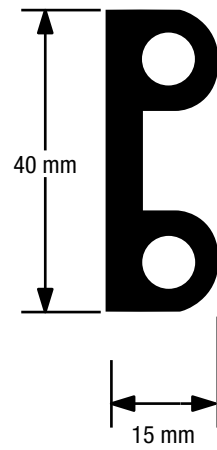

ACTUAL SIZE

## DUMP DOOR SEAL

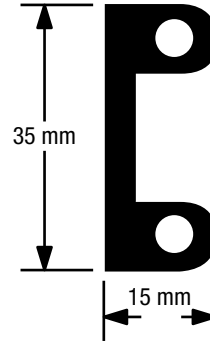

DR16 ACTUAL SIZE

## WIPER SEAL

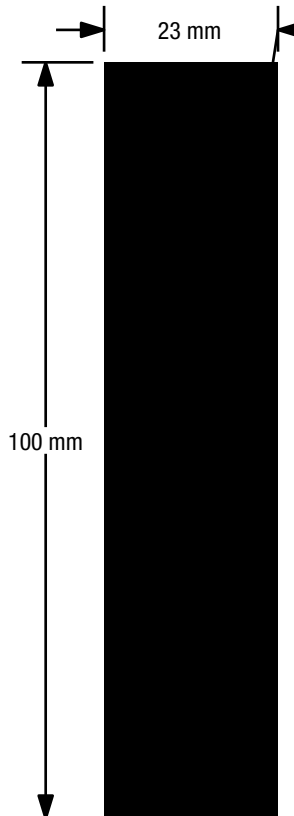

ACTUAL SIZE

Available in 6 metre lengths.

Derby Rubber waste compactor seals are compounded from Neoprene\* rubber giving excellent resistance to a wide range of chemicals.

B, Mini B and DR16 seals available in 3.3, 4 and 6 metre lengths.

Wiper seals available in 6.0 metre lengths or cut to customer specification.

Derby Rubber seals are designed to suit most waste compactors.

Neoprene\* is a registered trademark to DuPont.  
Commerical tolerance of  $\pm 3\%$  apply to all dimensions.

84 Derby Street  
Silverwater NSW 2128  
AUSTRALIA

v.11-02

tel. +61 2 9648 4911  
fax. +61 2 9648 4783

www.derbyrubber.com.au



# WASTE COMPACTOR SEALS

# product data sheet

## SOFTY WASTE COMPACTOR SEALS

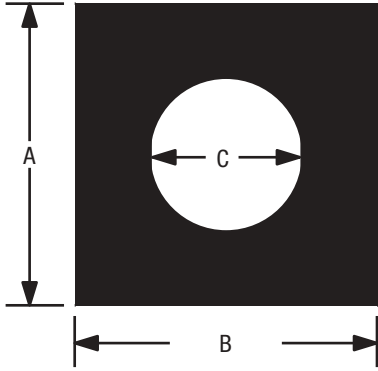

SOFTY 40 ACTUAL SIZE

PRODUCT CODE	A (mm)	B (mm)	C (mm)
SOFTY 20	20	20	10
SOFTY 25	25	25	10
SOFTY 30	30	30	19
SOFTY 40	40	40	20

Offering super compressibility.  
Available in 6.0 and 12.0 metre lengths.

Commercial tolerance of  $\pm 3\%$  apply to all dimensions.

## HATCH SERIES WASTE COMPACTOR SEALS

Compounded from Neoprene rubber giving excellent resistance to a wide range of chemicals.  
Available in 3.3, 4.0 and 6.0 metre lengths.

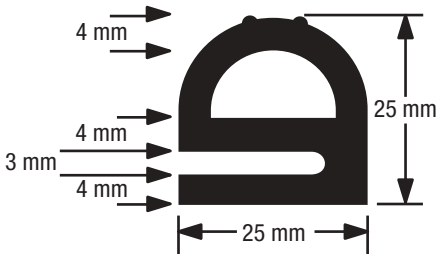

MINI HATCH

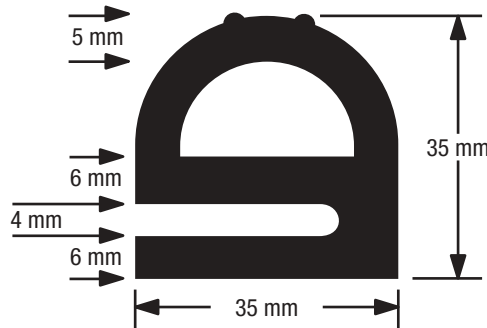

HATCH

## CHANNEL SERIES COMPACTOR SEALS

A wide range of sizes in both A and B dimensions are available.  
Made from long lasting sponge rubber.  
Suitable where large variation in sealing surfaces are encountered.

Minimum quantities of 6m lengths.

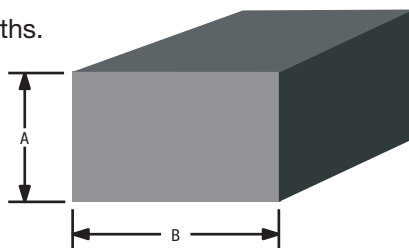

84 Derby Street  
Silverwater NSW 2128  
AUSTRALIA